

Add-on options

We offer the suitable solutions depending on your experiments.

Program fluidic control system

Perfusion, Media Exchange, Drug Delivery and Mixing can be easily programmed and done without disturbing your sample.

- Model PMD-D35**
 *For STX/STR/INU Chamber
 *For 35mm dish
System Image
 <Controller>
- [Specification]**
 Continuous Perfusion : 40 μ L/min ~ 100 μ L/min
 Media Exchange volume : 0.5ml ~ 5.0ml
 Media Exchange Number : Maximum 10 times
 Drug Delivery : 20 μ L ~
 Controller size : W175 x D175 x H195 (mm)

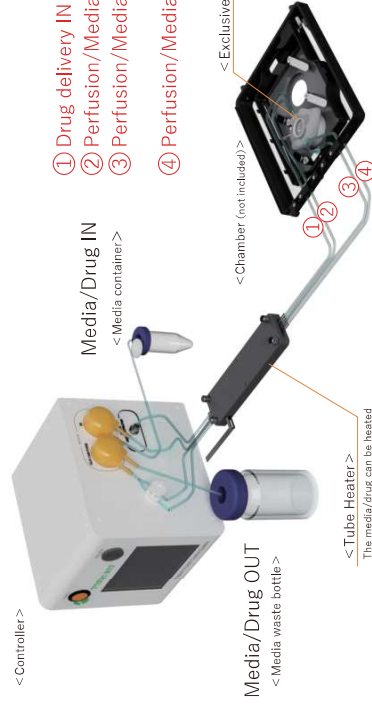

- [Components]**
 - Controller
 - Tube Heater
 - Media containers (For perfusion, Media Exchange)
 - Multi Fluidic Lid (PMD-D35FME) for 35mm dish
 - Diamond Insert (KS-DIA) for 35mm dish (100 μ l media exchange)
 *Media waste bottle is not included
- Enables to mix the media and drug to be uniformly after the drug delivery.
 - Setting of suction / supply liquid volume at a finer flow rate is possible.
 - Regulates the system with TTL IN/OUT.
 - High-repeatability experiments are possible by keeping the media level evenly.
 - With a built-in tube heater, one fluidic control system can be completed with one system.
 - Supports general 35mm dish.
 - Manages each user's program individually by using USB memory.

Perfusion/Media exchange system

Perfusion/Media exchange without removing a dish lid is possible. Prevents media evaporation and contamination during long-term imaging.

- Model KSX-Type1** *For STX/STR Chamber
KS-Type1 *For INU Chamber

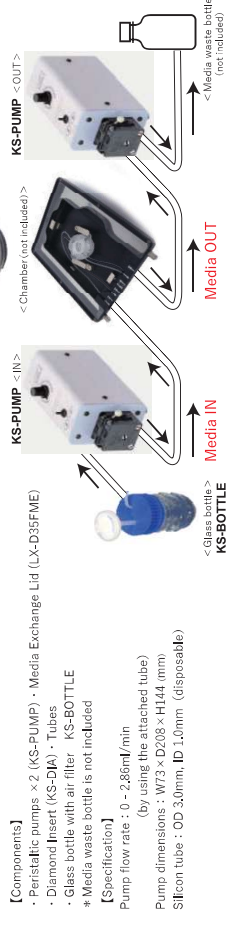

One-push drug delivery system

Rapid and vibration-free drug delivery is possible. Prevents media evaporation and contamination during long-term imaging.

- Model KSX-Type2** *For STX/STR Chamber
KS-Type2 *For INU Chamber



Digital Gas Mixer

Digital Gas Mixer for Stage Top Incubator. You can choose depending on the usage gas cylinder.

For STX series

Model STX-CO202
 For low oxygen (Hypoxia)
 O₂ concentration : 0.1 ~ 18.0%
 CO₂ concentration : 5.0 ~ 20.0%
 Gas cylinder : 100%CO₂ & 100%N₂
 Dimensions : W160 x D271 x H250 (mm)

Model STX-CO2
 For CO₂ concentration
 CO₂ concentration : 5.0 ~ 20.0%
 Gas cylinder : 100%CO₂
 Dimensions : W115 x D271 x H250 (mm)
 * For STX Controller

Model STX-O2
 For O₂ concentration
 O₂ concentration : 0.1 ~ 18.0%
 Gas cylinder : 100%N₂
 Dimensions : W115 x D271 x H250 (mm)
 * Must use with STX-CO2

Stand alone

Model GM-8000
 For low oxygen (Hypoxia)
 O₂ concentration : 0.1 ~ 18.0%
 CO₂ concentration : 5.0 ~ 20.0%
 Gas cylinder : 100%CO₂ & 100%N₂
 Dimensions : W160 x D260 x H187 (mm)

Model GM-3000
 CO₂ concentration & flow rate
 CO₂ concentration : 1.0 ~ 20.0%
 Flow rate : 50 ~ 200 ml/min
 Gas cylinder : 100%CO₂
 Dimensions : W121 x D174 x H157 (mm)

Mini CO2 regulator

* MG1 is only available in the US and Japan at this moment. There is no need to prepare a large gas cylinder and no regulator operation is required. The gas is supplied at the optimal flow rate for the Tokai Hit incubator with one push.

Model MG1

- [Specification]**
 Output gas pressure: 0.1 MPa
 Usable time: about 3 days / 1 cartridge
 Dimensions: W135 x D182 x H237 (mm)
 Weight: 2.5 kg

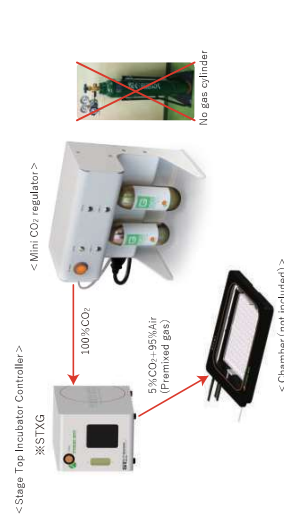

- Consumable gas cartridge
 Consumable gas cartridge is available.
 Please contact LELAND with the part number: 88100Z.
 - Cartridge size: 74 g
 - Thread design: 5/8 - 18UNE

